

INDEX

GENERAL DETAILS

Details Index.....	1
General.....	2
Detail Locator	3
Roof Panel Sections - RollLok Seam	4
Roof Panel Sections - TripleLok Seam.....	5
Roof Panel Section - QuadLok Seam.....	6
Eave Section — Eave Trim.....	7
Eave Section — Eave Gutter	8
Roof Panel Endlap Section.....	9
Ridge Section	10
High Eave Section - High Eave Trim	11
High Eave Section - Transition Flashing	12
Starting Rake Section - Rake Trim	13
Finish Rake Section - Rake Trim	14
Rake Section - Transition Flashing	15
Hip Section	16
Valley Section	17
Valley Gutter Suction	18
Interior Eave Gutter Section	19
Roof Sections - Fiberglass Insulation.....	20
Roof Sections - Fiberglass Insulation With Thermal Spacers	21
Roof Sections - Rigid Foam Insulation	22

GENERAL

The following Architectural Details provide a graphic description of the “XYZ” Company” Standing Seam Roof System and it’s standard applications. Use these details to determine the applications required for your specific project.

These standard application details are based on typical and proven designs utilizing gasket type sealed assemblies to provide more positive weather resistance over a broad range of conditions, including low pitched roofs. It is the project designer’s responsibility to assure that the specified application is appropriate for the roof’s intended use.

These details show generic roof structural members, roof insulation and adjacent construction for simplicity of presentation. These details may be modified to accommodate clarification of structural members, roof insulation, trim profile, tie-in to adjacent construction etc.
The basic function of the details, such as roof panel as-

sembly and fit-up to closures and flashing, sealing and attachments etc. cannot be modified. All applications, not in accordance to these details, require approval by the “XYZ” Company” Customer Service Department.

In case of conflict between these Architectural details and the project’s erection drawings, the erection drawings will take precedence.

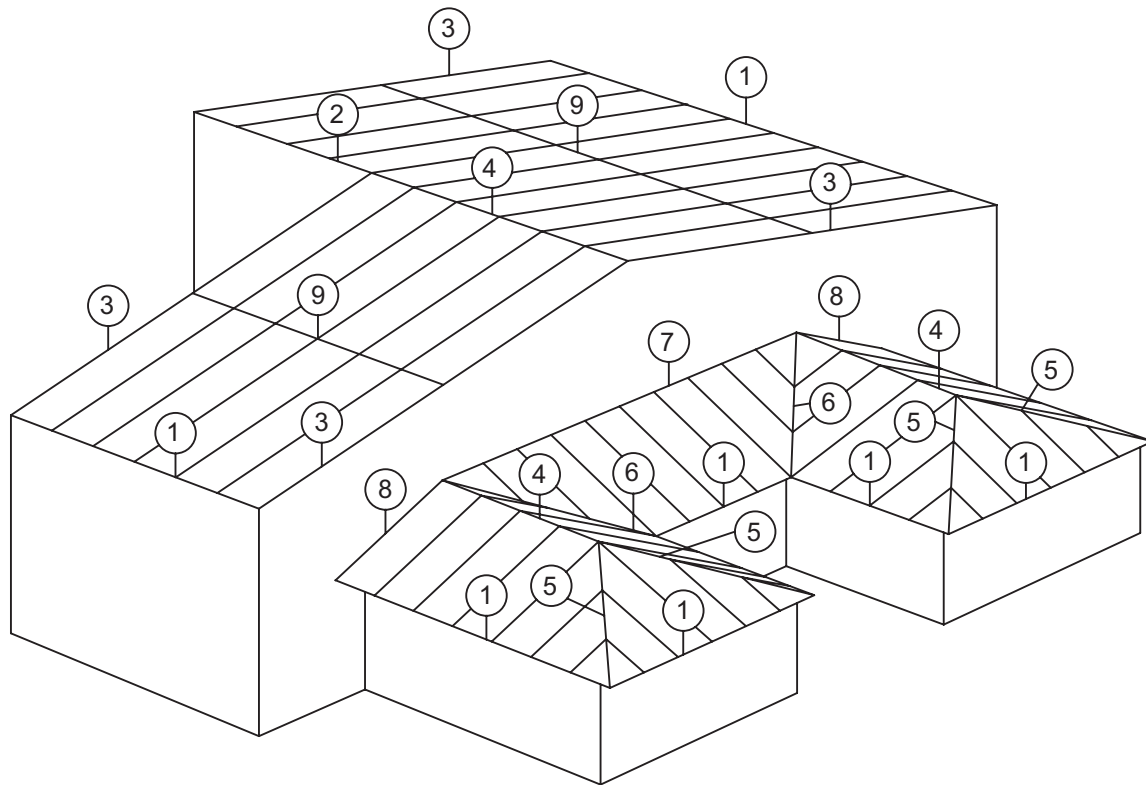

DETAIL LEGEND

- ①.....EAVE
- ②.....HIGH EAVE
- ③.....RAKE
- ④.....RIDGE
- ⑤.....HIP
- ⑥.....VALLEY
- ⑦.....HIGH EAVE TRANSITION
- ⑧.....RAKE TRANSITION
- ⑨.....ROOF PANEL ENDLAP

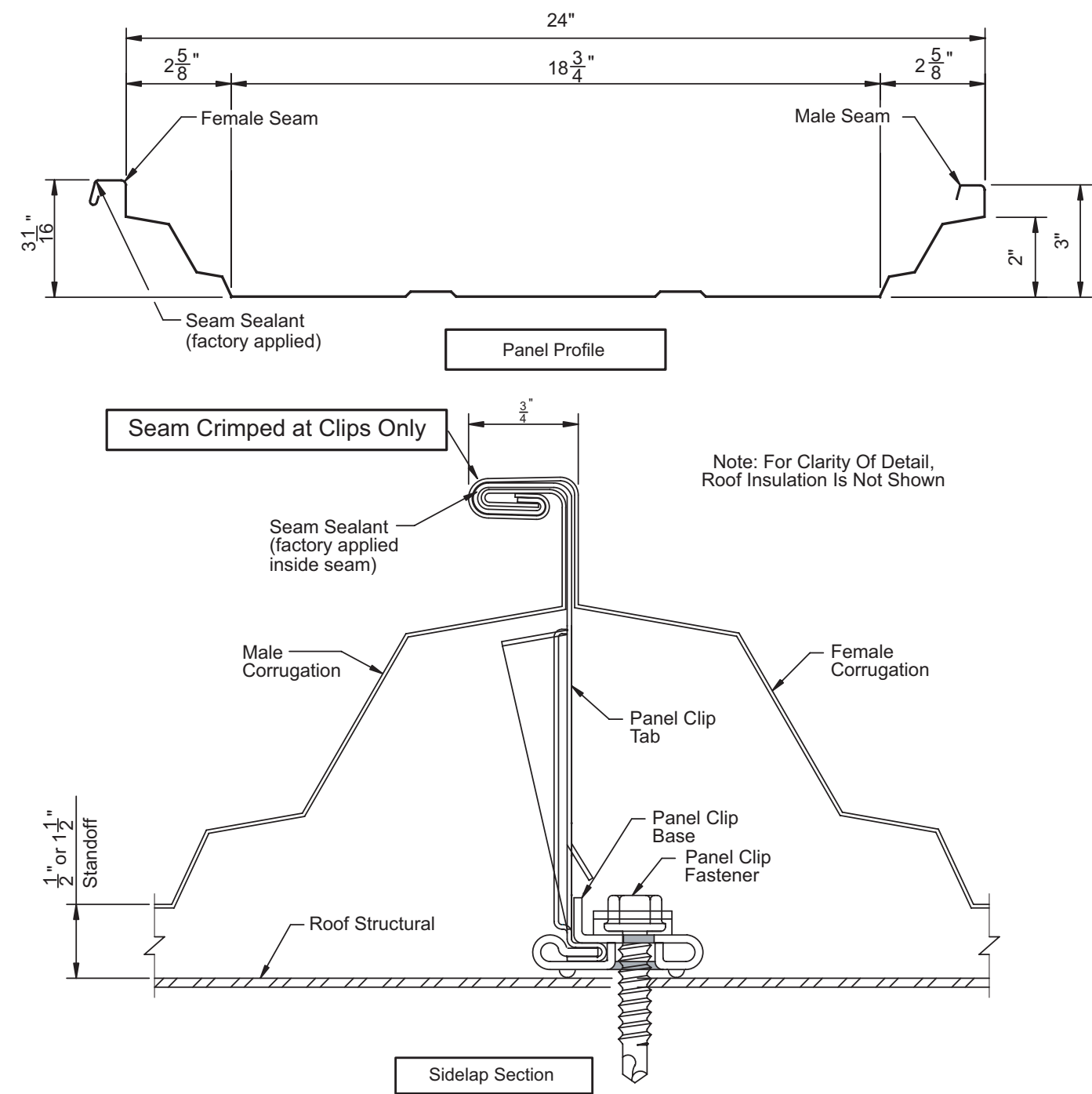

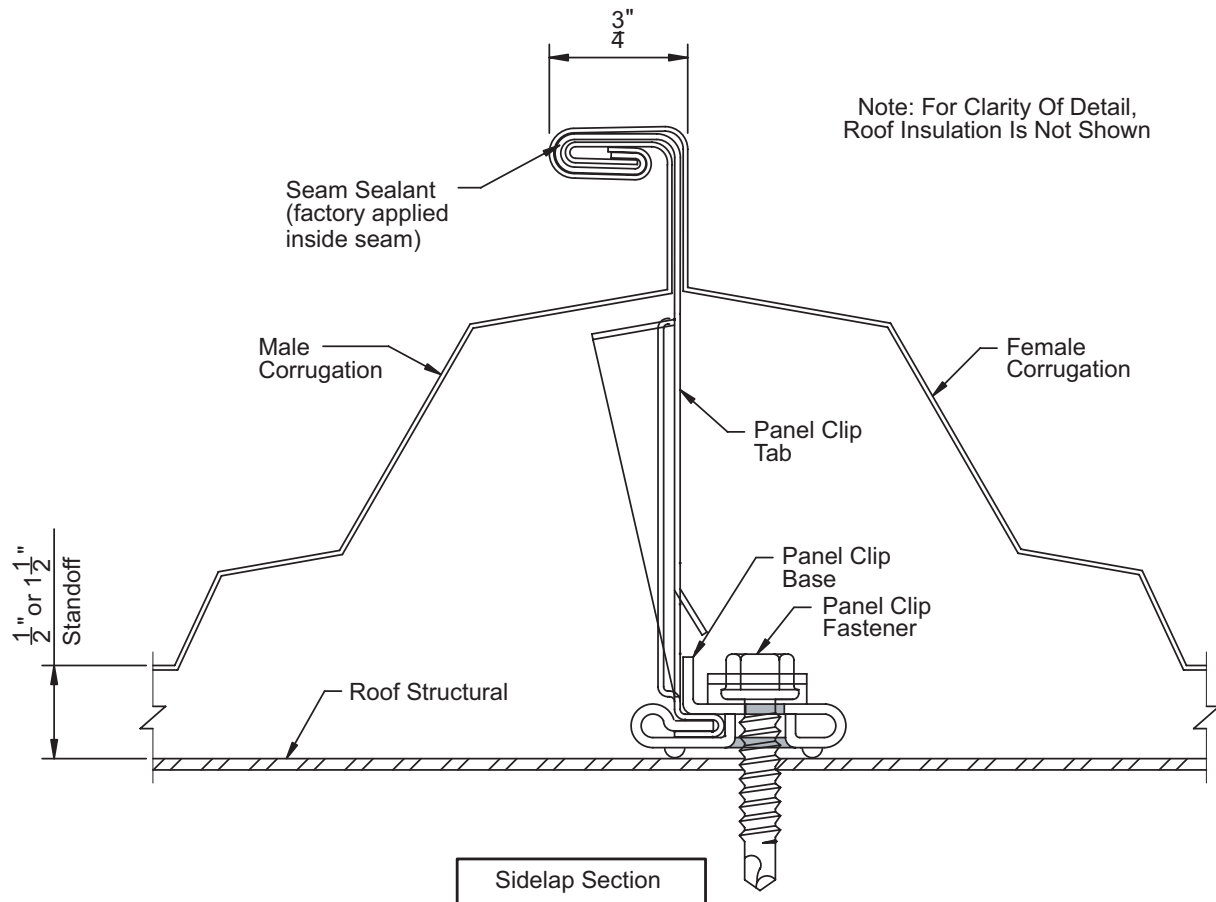
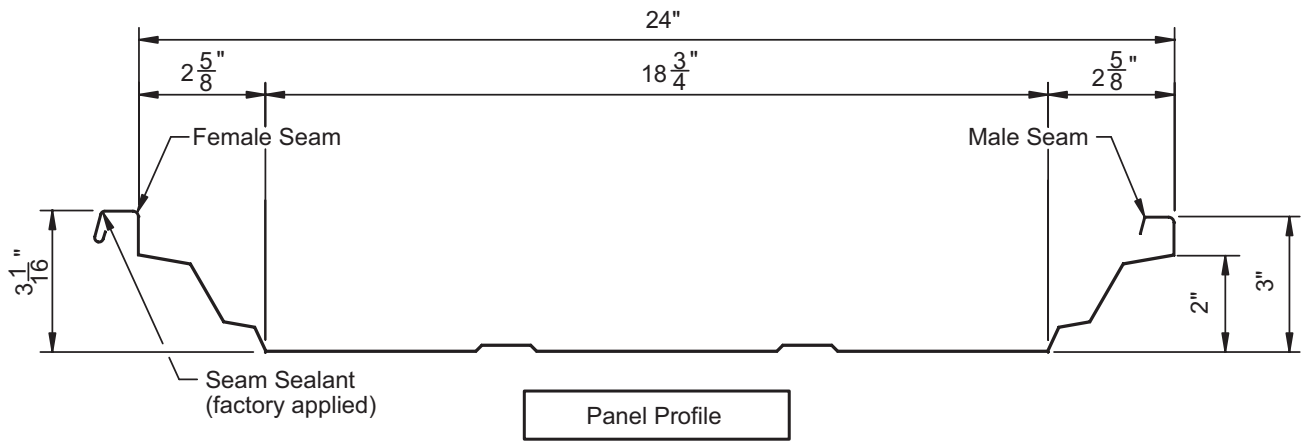

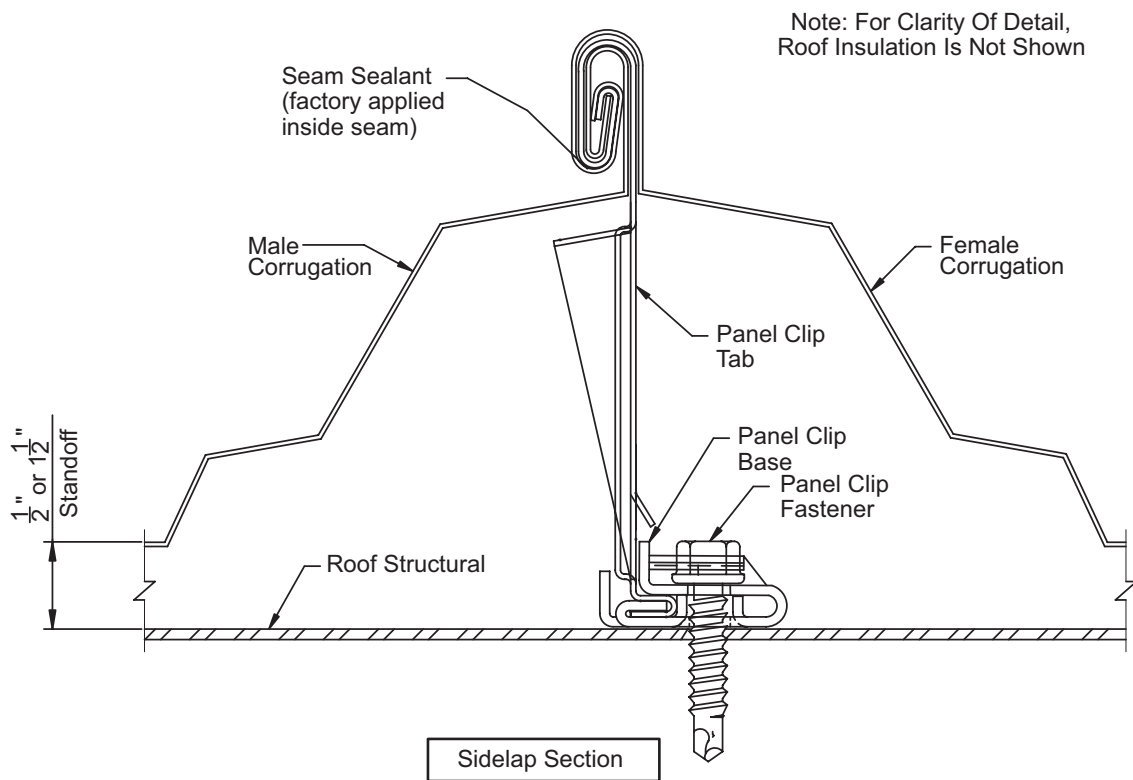
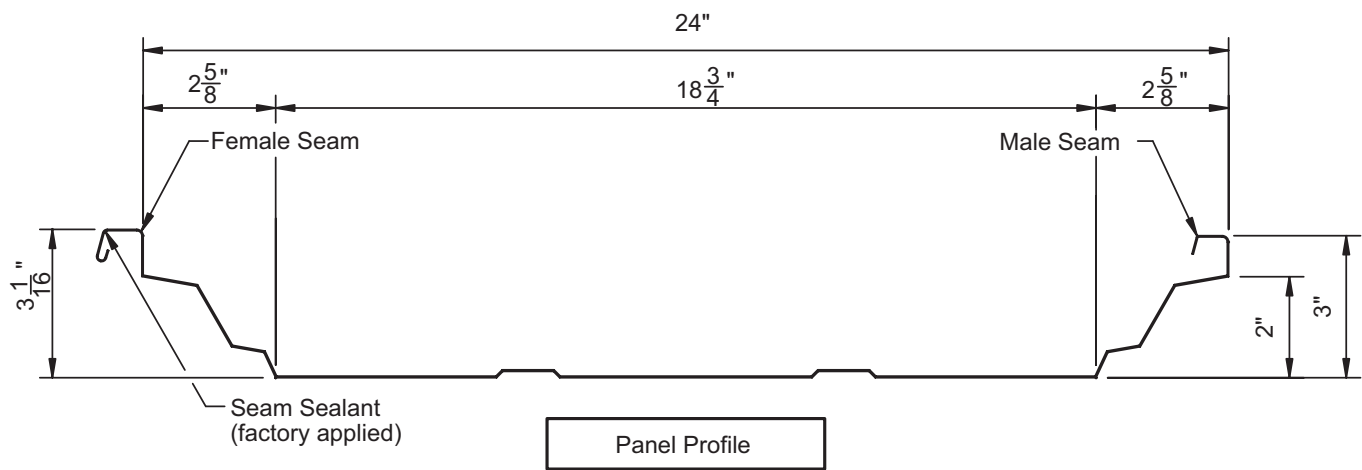

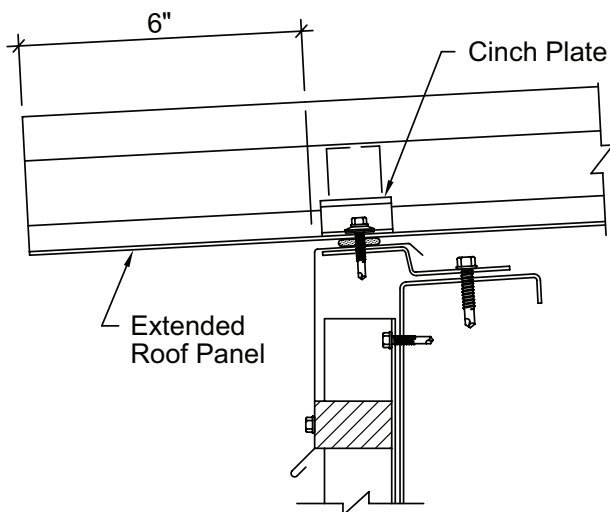
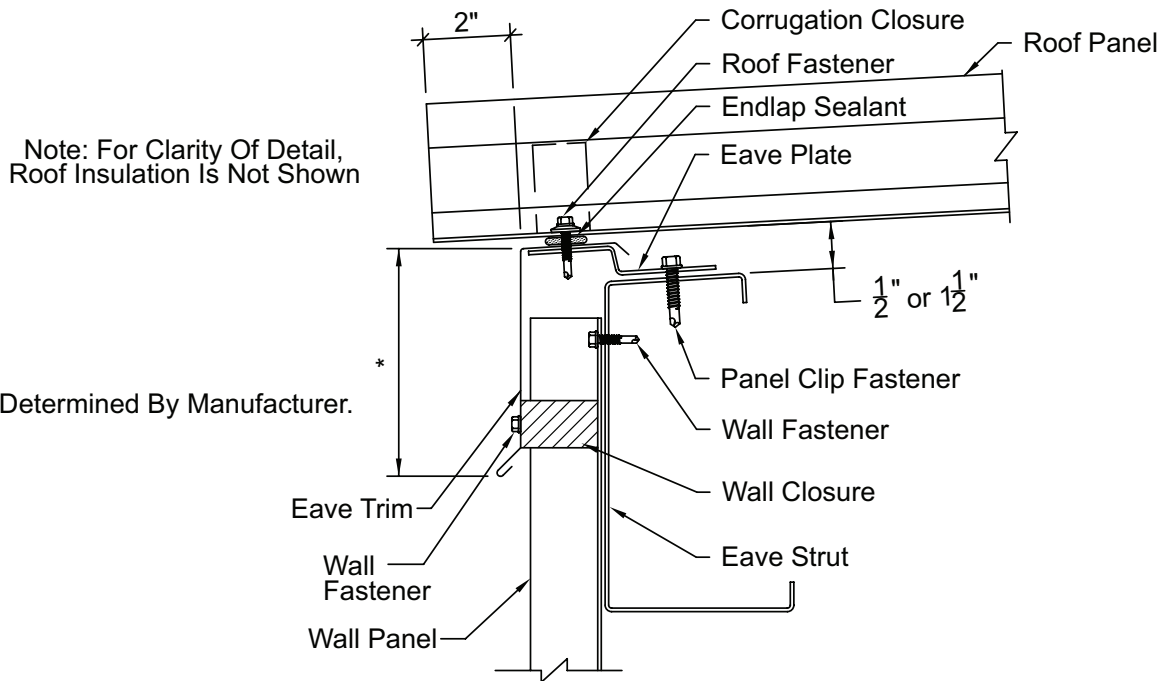

Alternate Cinch Plate And
Extended Roof (For Heavy
Snow And Ice Areas)

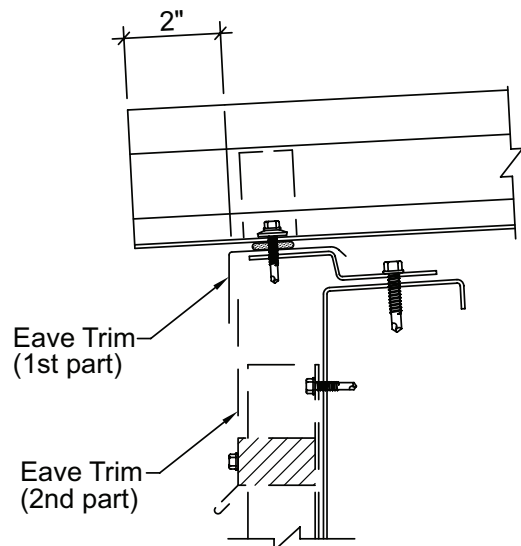

Alternate
Two Part Eave Trim (To Allow
Installation Of Wall Panel After
Roof Is In Place)

Note: For Clarity Of Detail,
Roof Insulation Is Not Shown

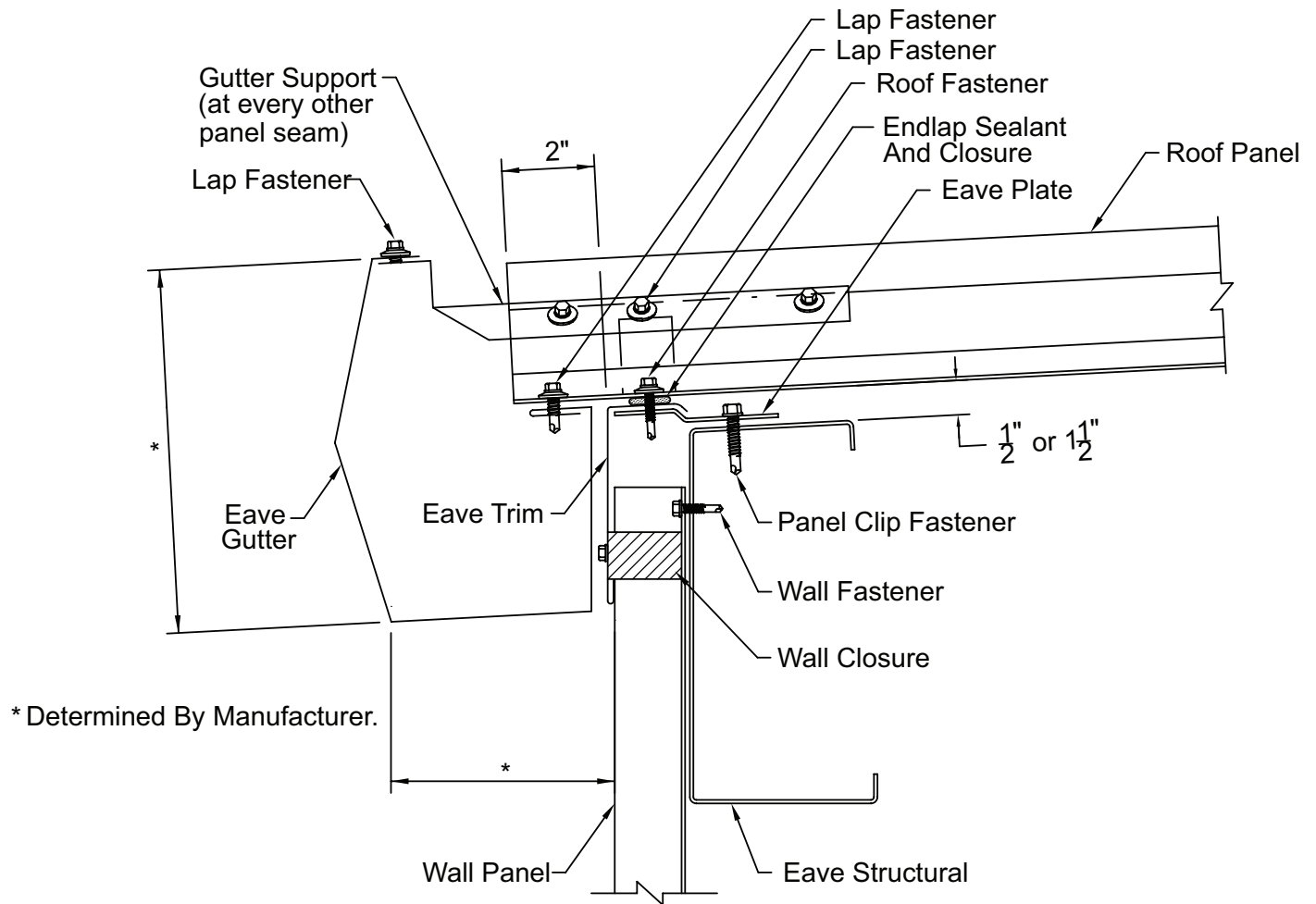

CAUTION
Gutter Is Not Recommended
For Areas That Experience Snow,
Ice, Extreme Rainfall Or Damming Conditions

Note: For Clarity Of Detail,
Roof Insulation Is Not Shown

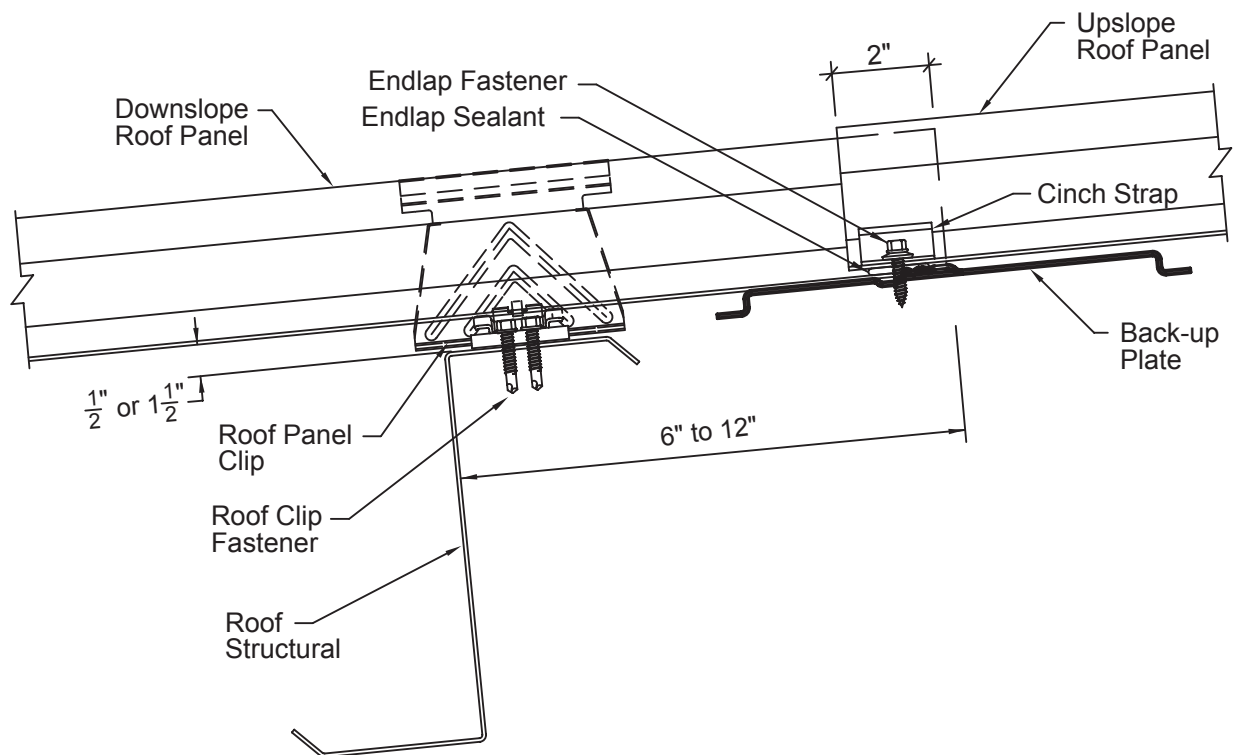

Note: For Clarity Of Detail,
Roof Insulation Is Not Shown

** Determined By Manufacturer

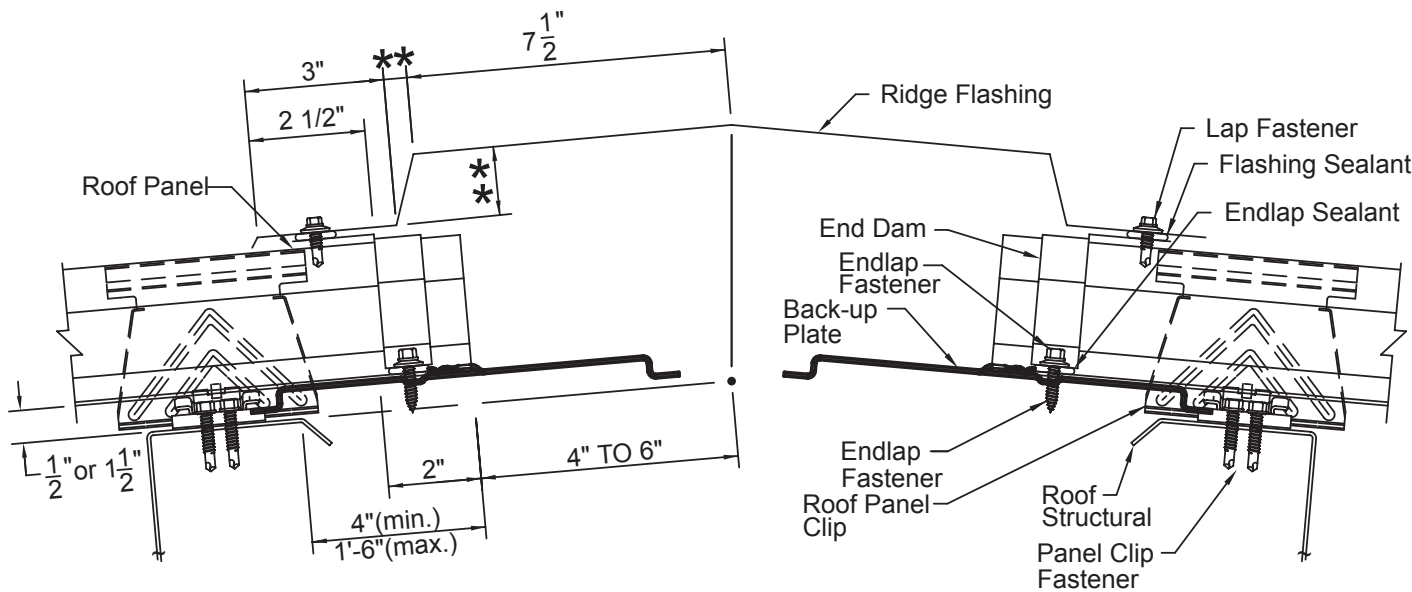

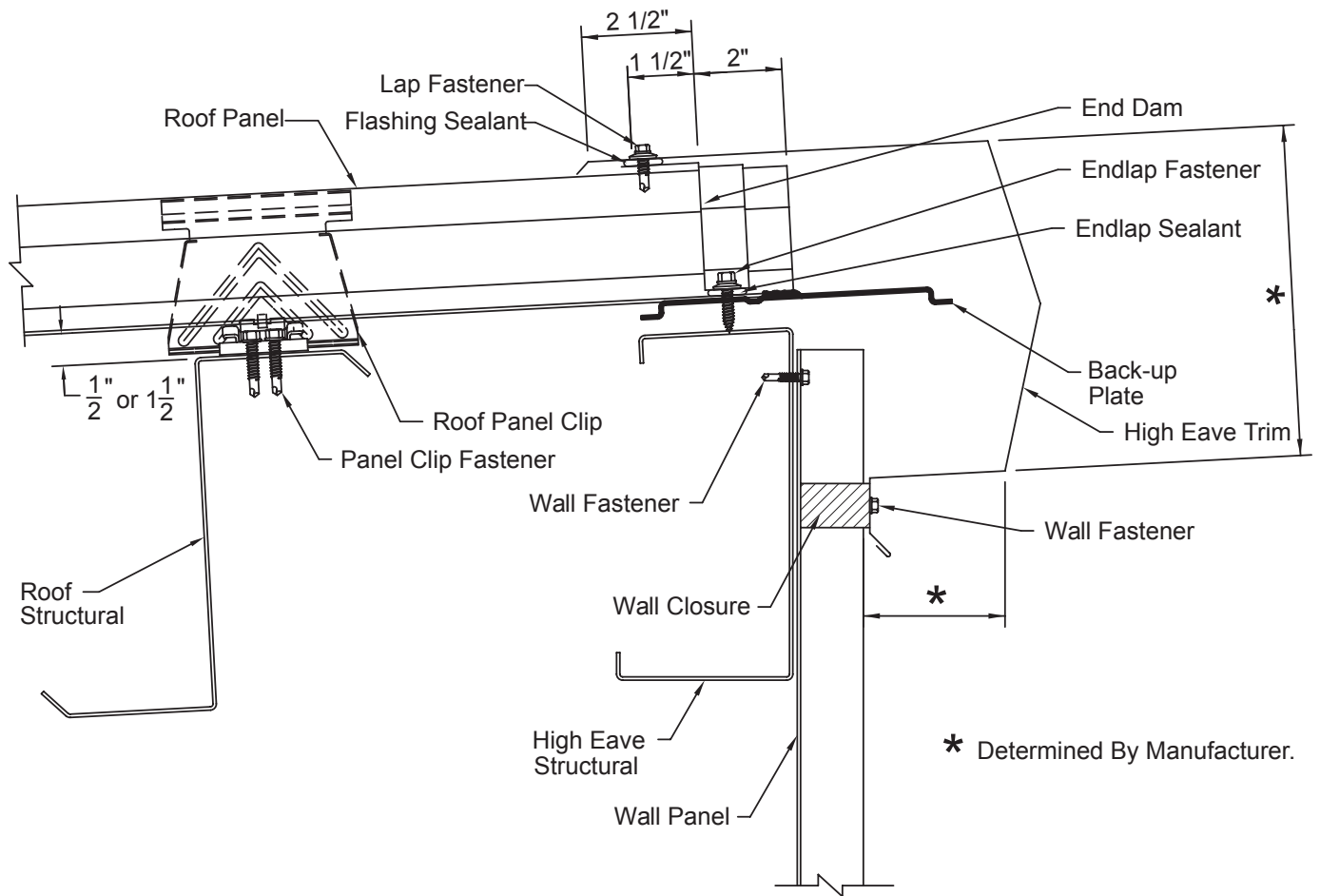

* Determined By Manufacturer.

Note: For Clarity Of Detail,
Roof Insulation Is Not Shown

** Determined By Manufacturer

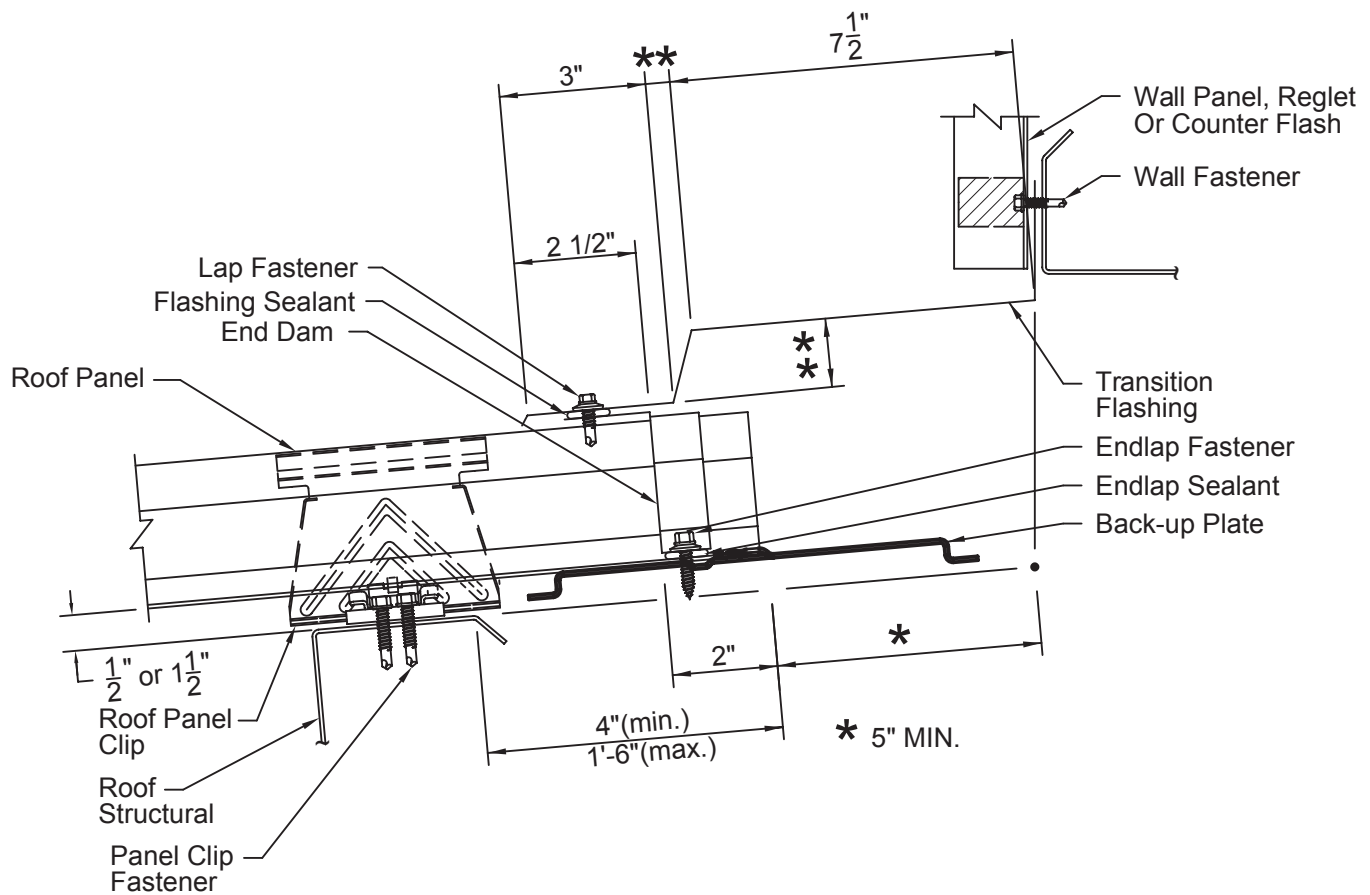

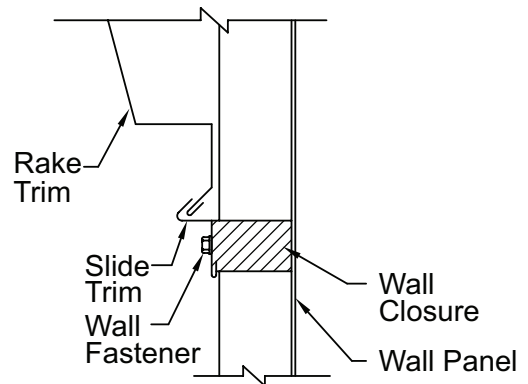
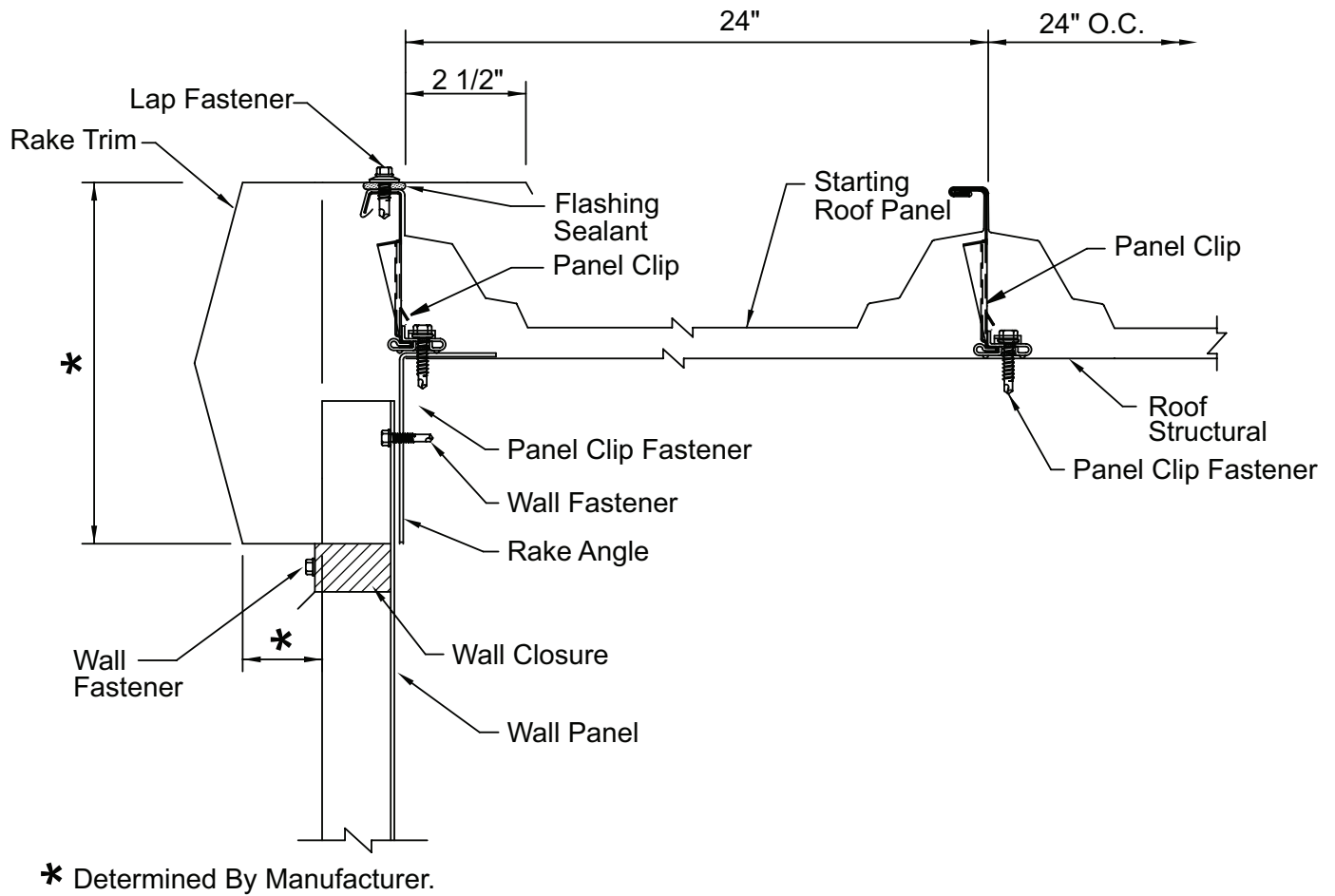

Alternate
Sliding Rake
Trim (Allows Expansion Movement Of Rake
Trim, Required When Roof Run Exceeds 50')

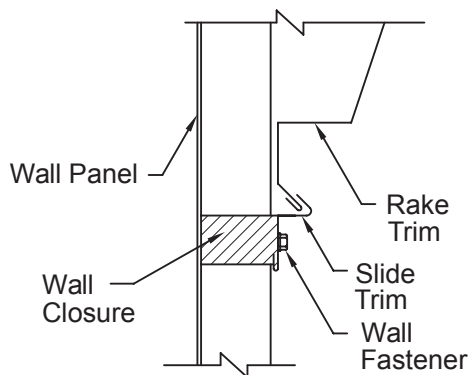
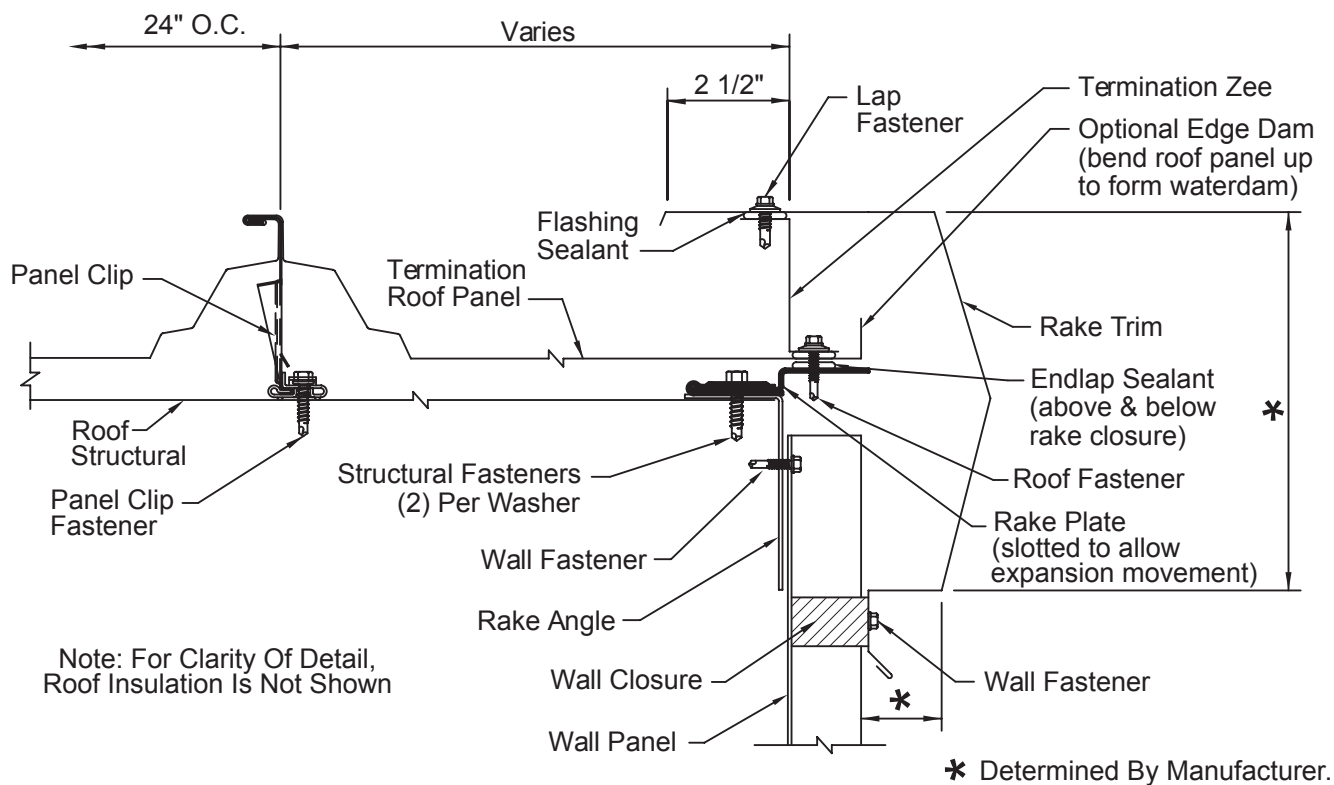

Alternate
Sliding Rake
Trim (Allows Expansion Movement Of Rake
Trim Required When Roof Run Exceeds 50')

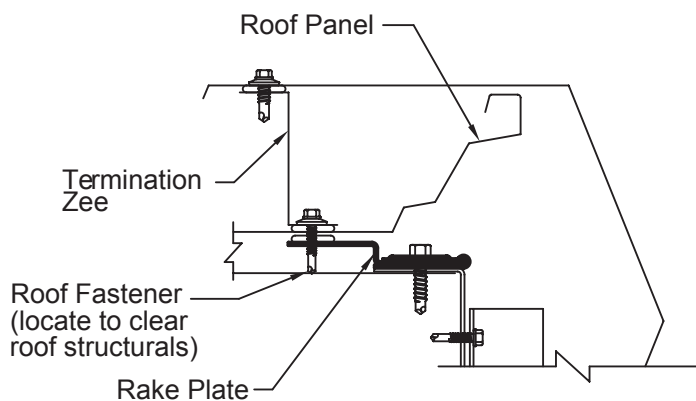

Alternate
Attachment To Full Width Roof Panel

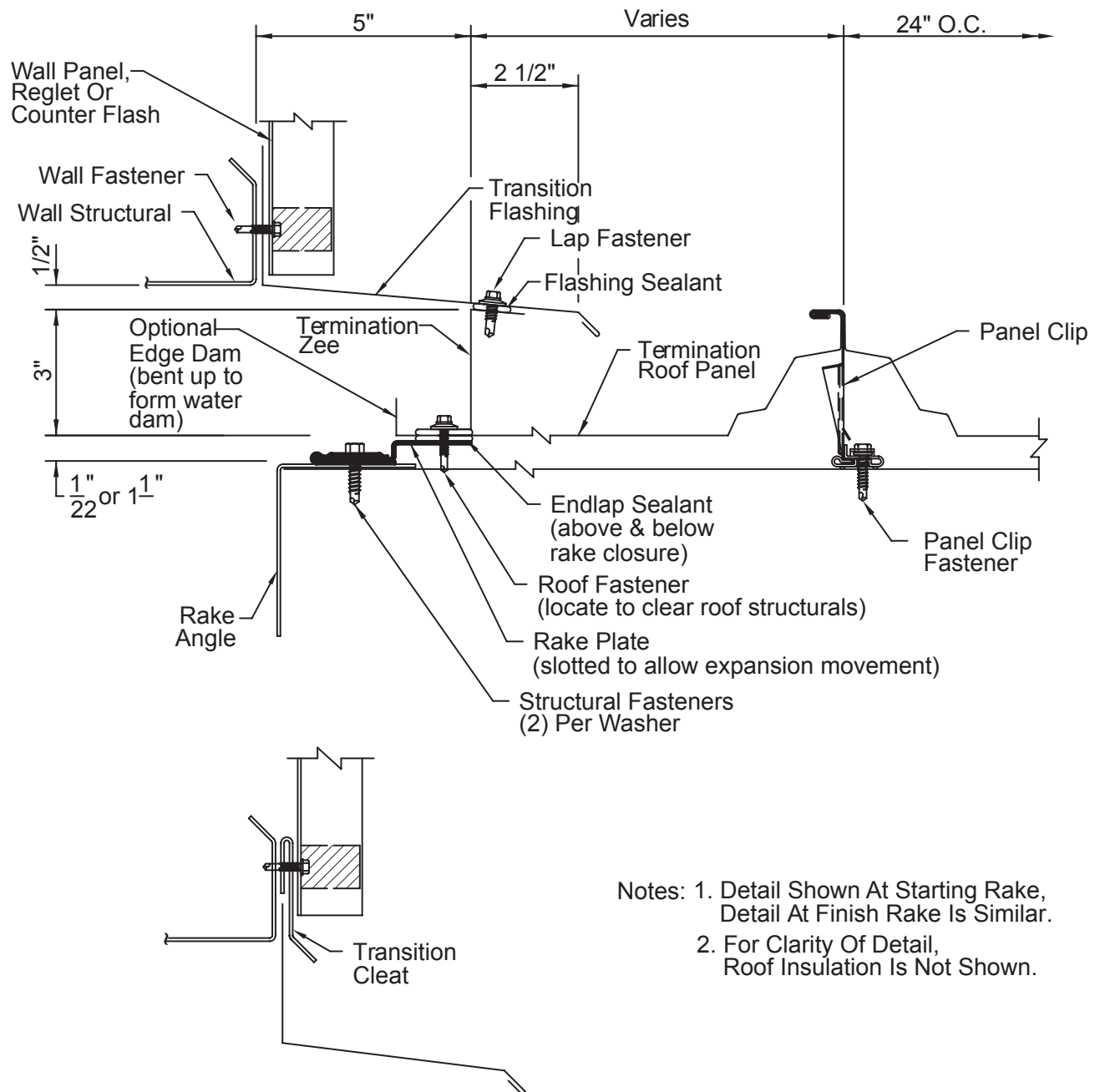

Alternate
Sliding Transition Flash
(Allows Expansion Movement Of
Transition Flash, Required When
Roof Run Exceeds 50')

Note: For Clarity Of Detail,
Roof Insulation Is Not Shown

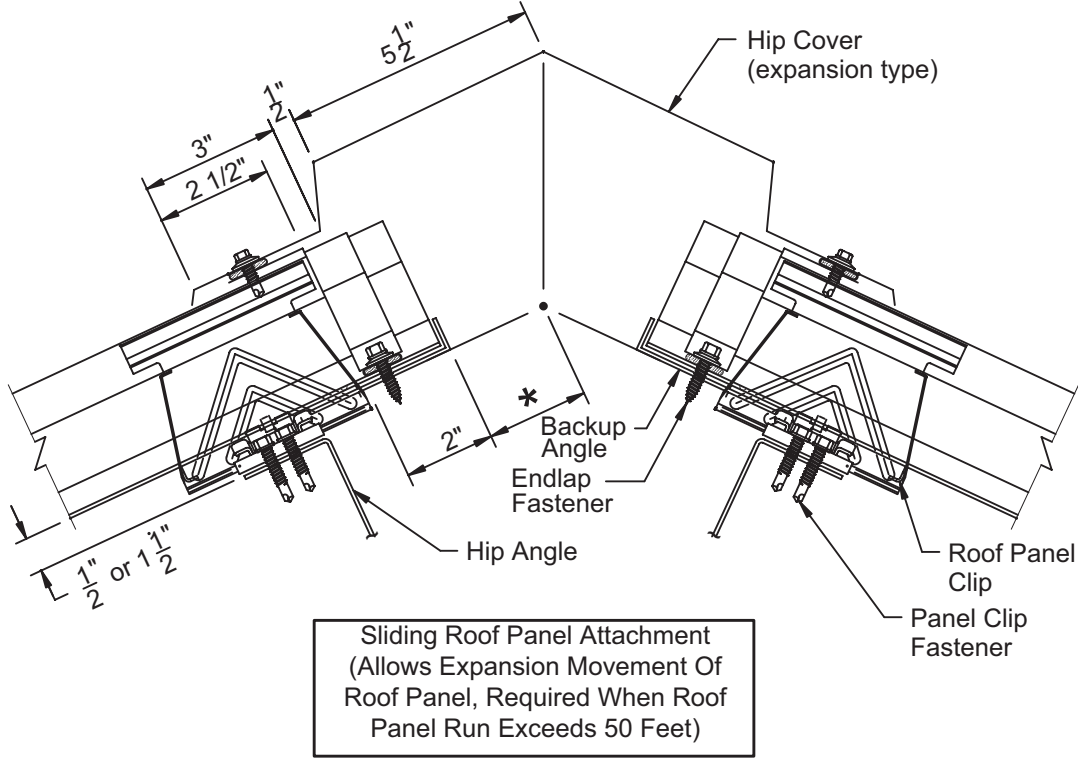
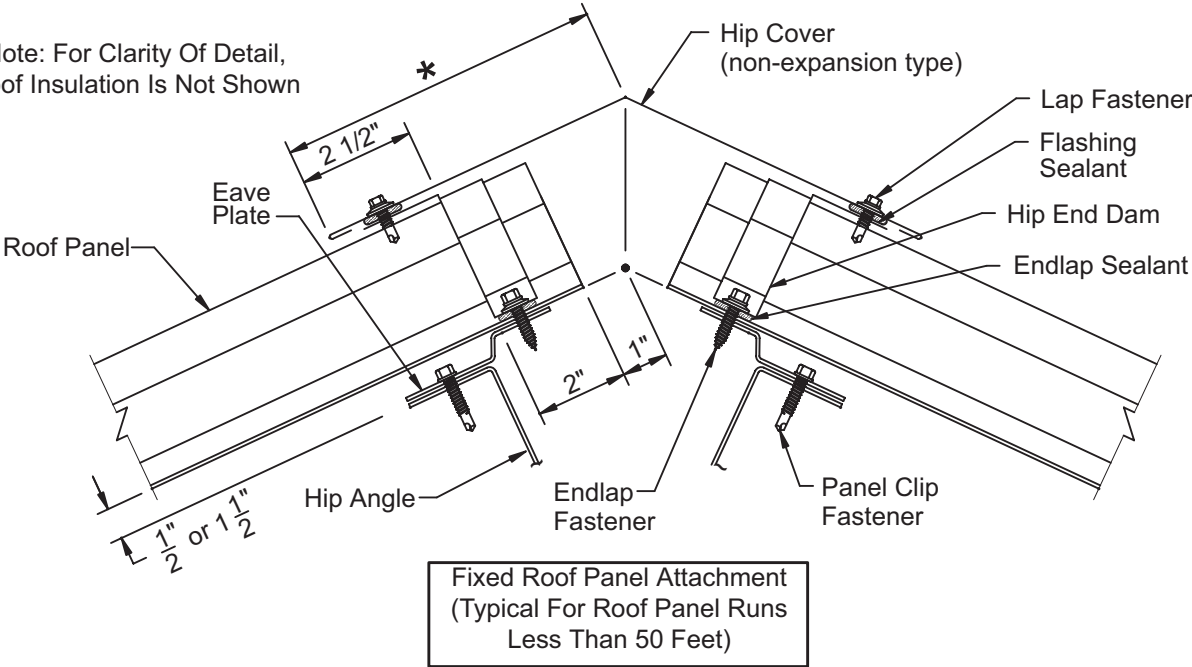

Note: For Clarity Of Detail,
Roof Insulation Is Not Shown

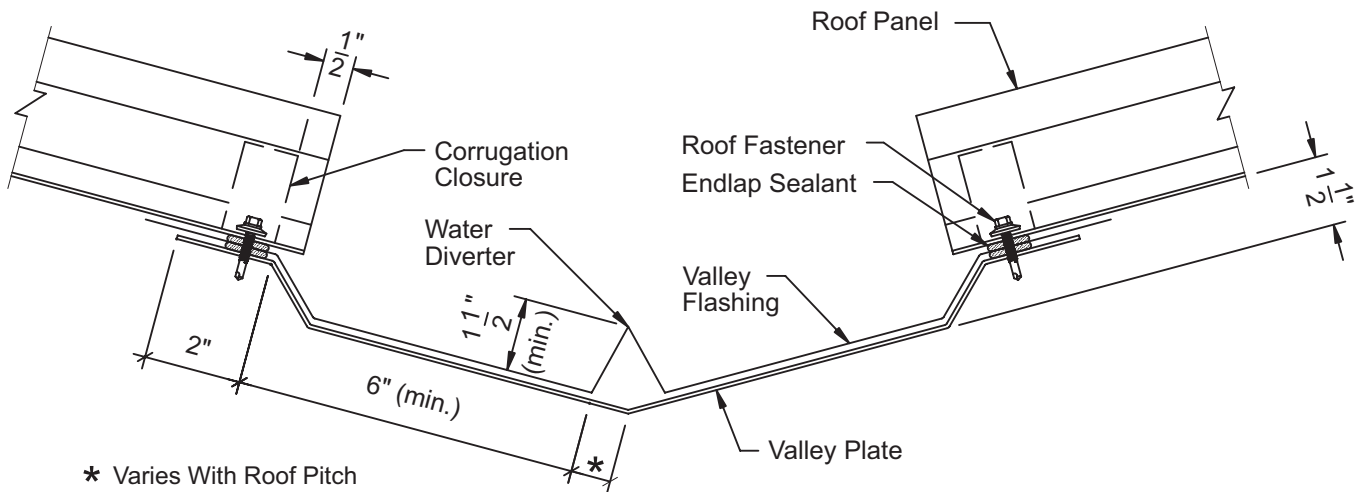

Valley For Roof Systems
With High Panel Clips

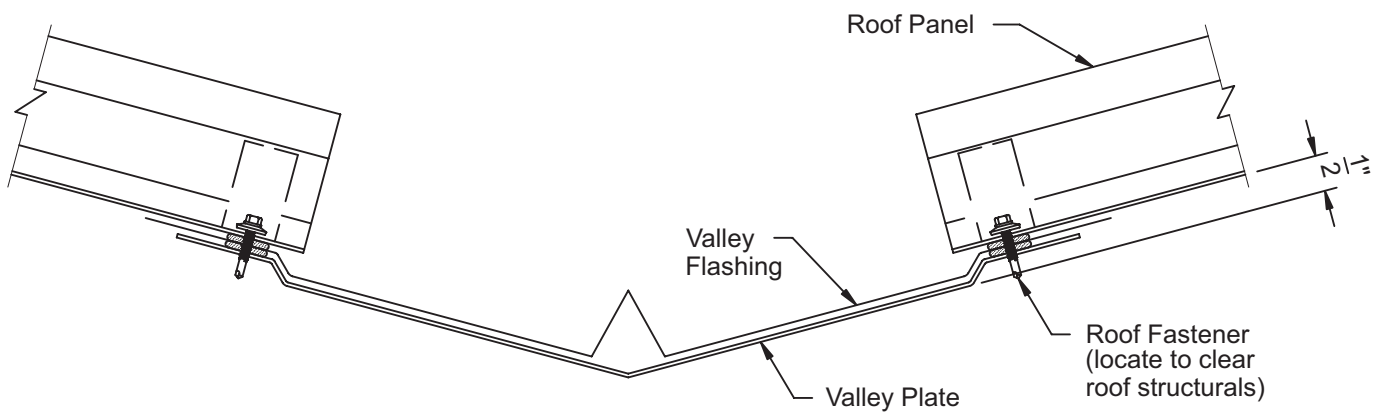

Valley For Roof Systems
With Low Panel Clips

Note: For Clarity Of Detail,
Roof Insulation Is Not Shown

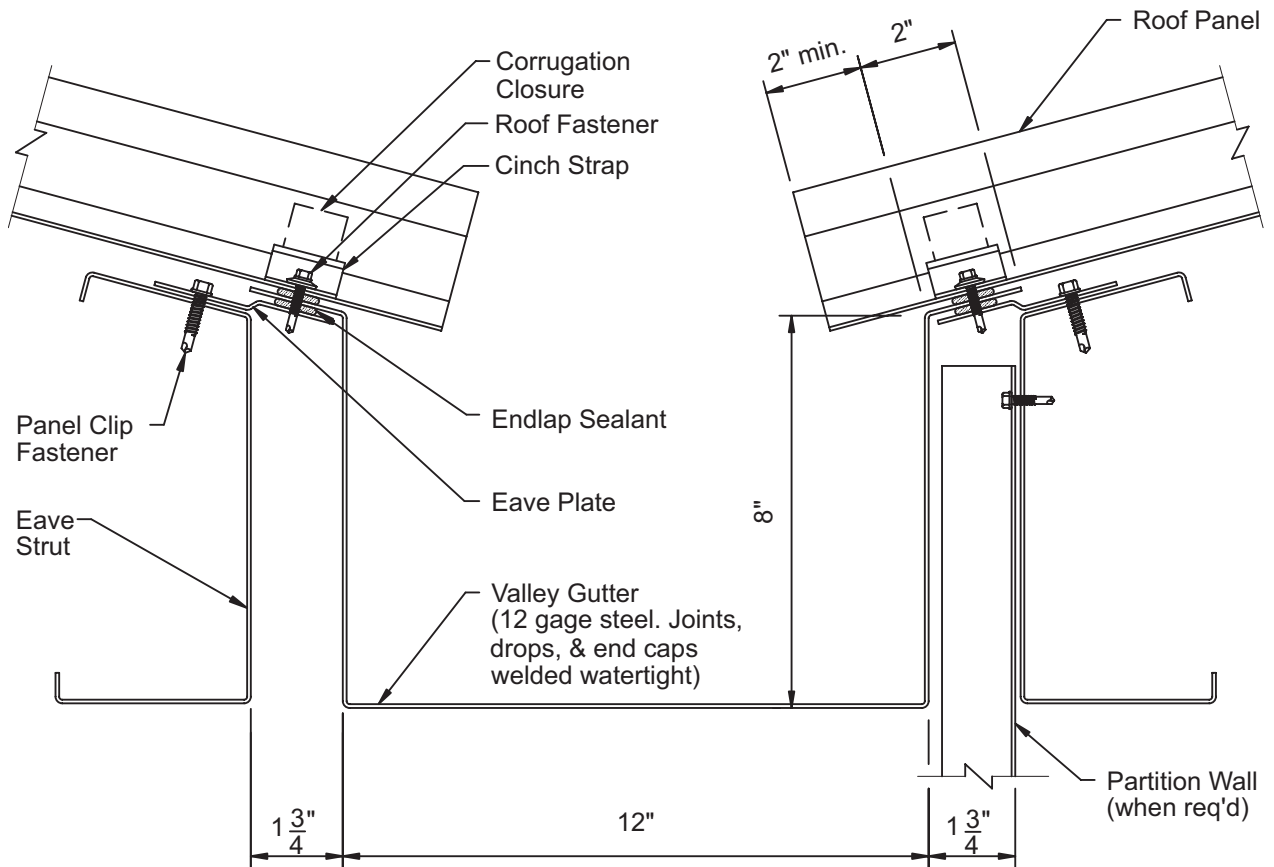

CAUTION
Interior Gutter Must Be Provided
With Protection From Corrosion,
Icing, Damming &
Interior Condensation

Note: For Clarity Of Detail,
Roof Insulation Is Not Shown

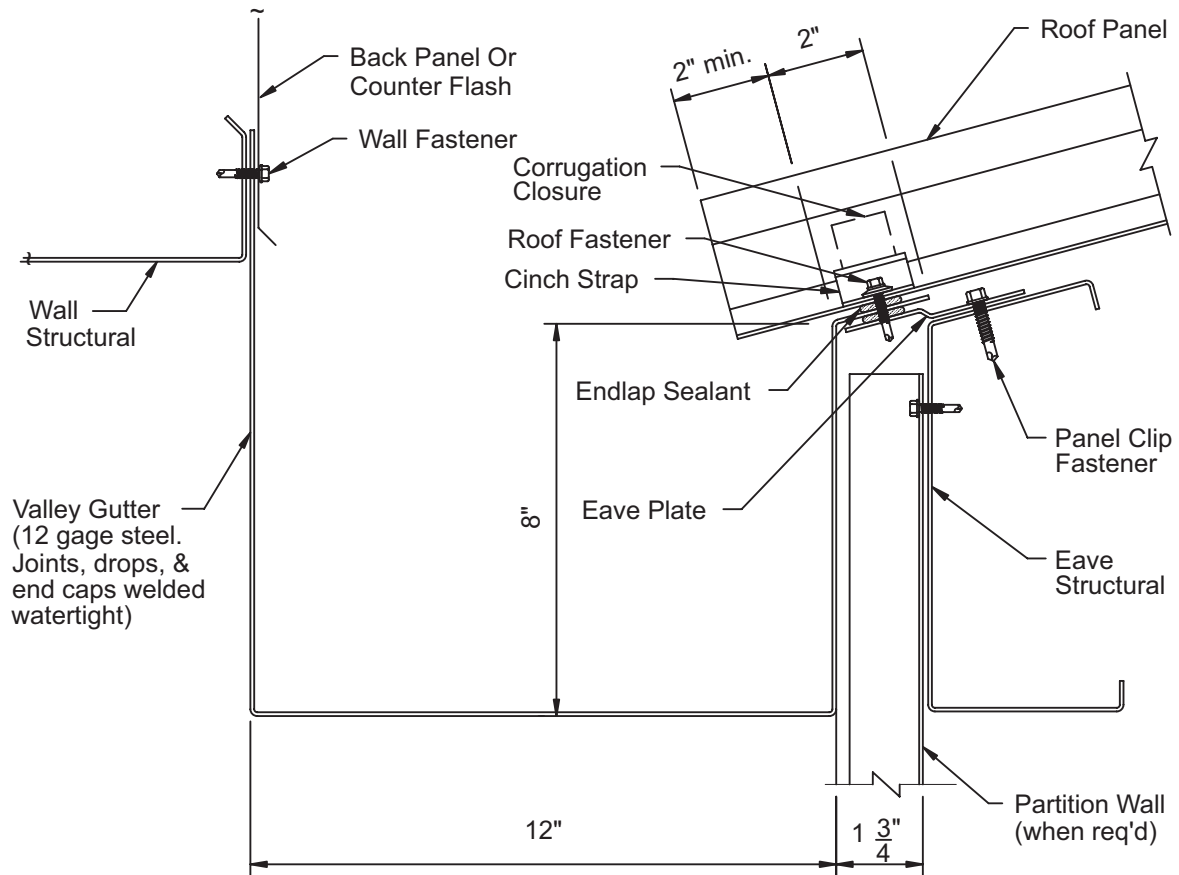

CAUTION
Interior Gutter Must Be Provided
With Protection From Corrosion,
Icing, Damming &
Interior Condensation

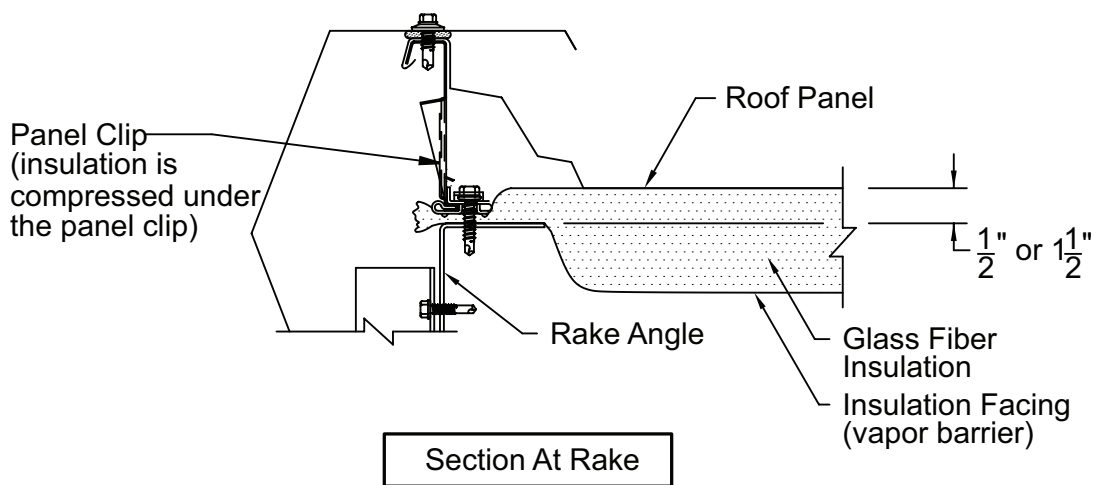
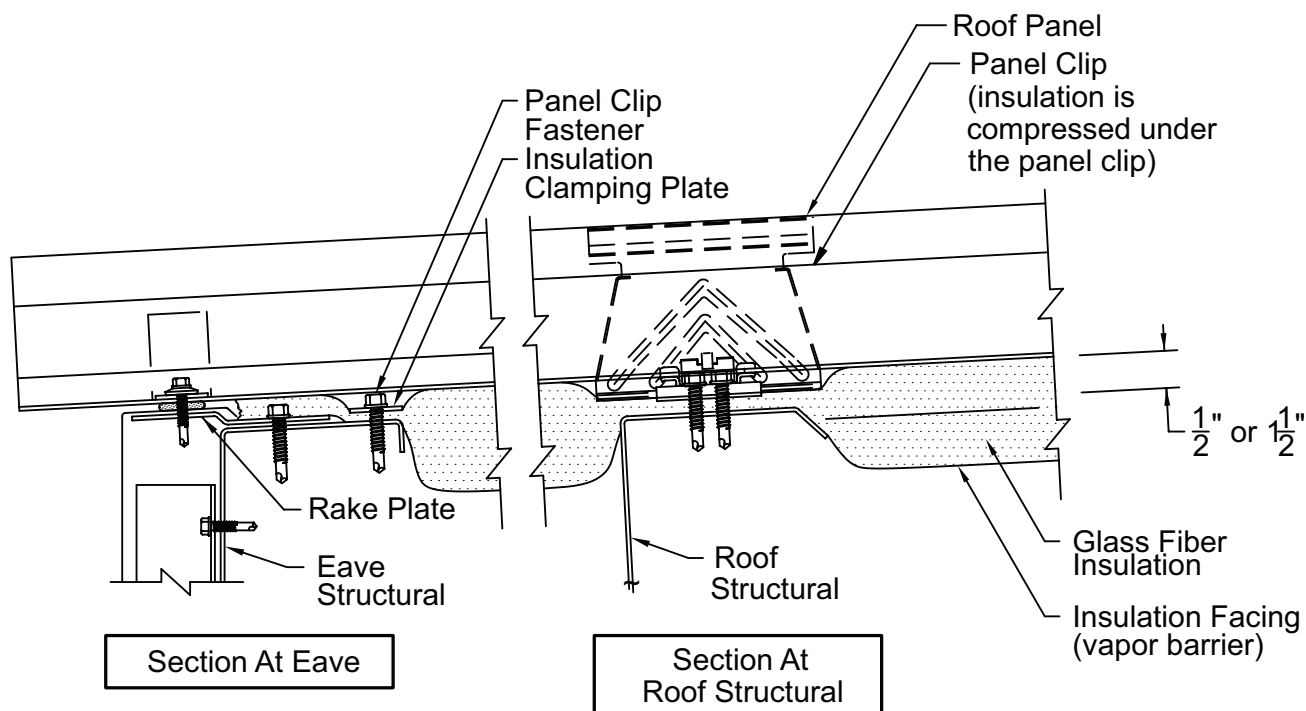

Insulation Note
 1/2" Standoff Is Recommended For Up To 4" Thick Insulation.
 1 1/2" Standoff Is Recommended For 4" To 6" Thick Insulation.

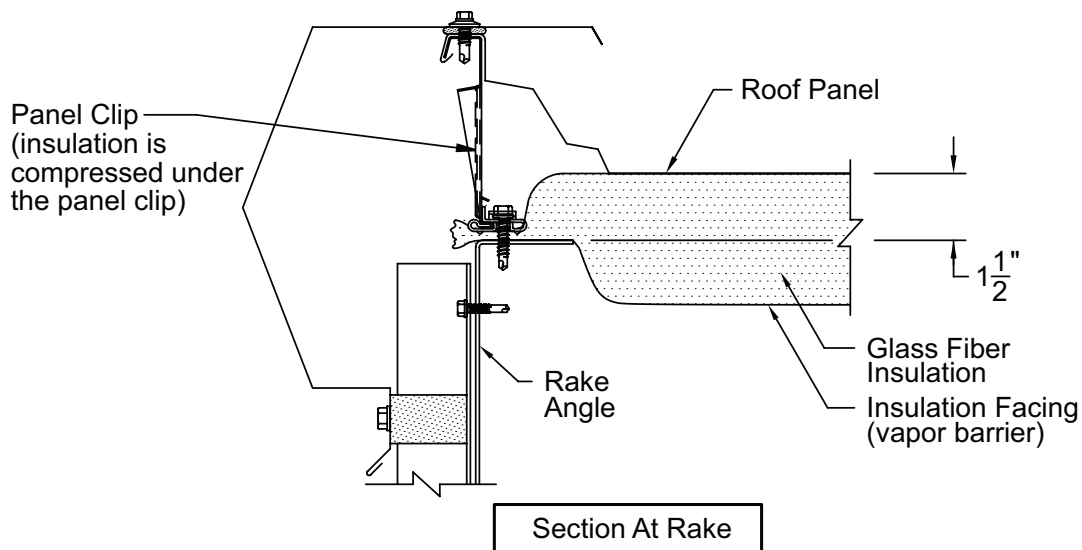
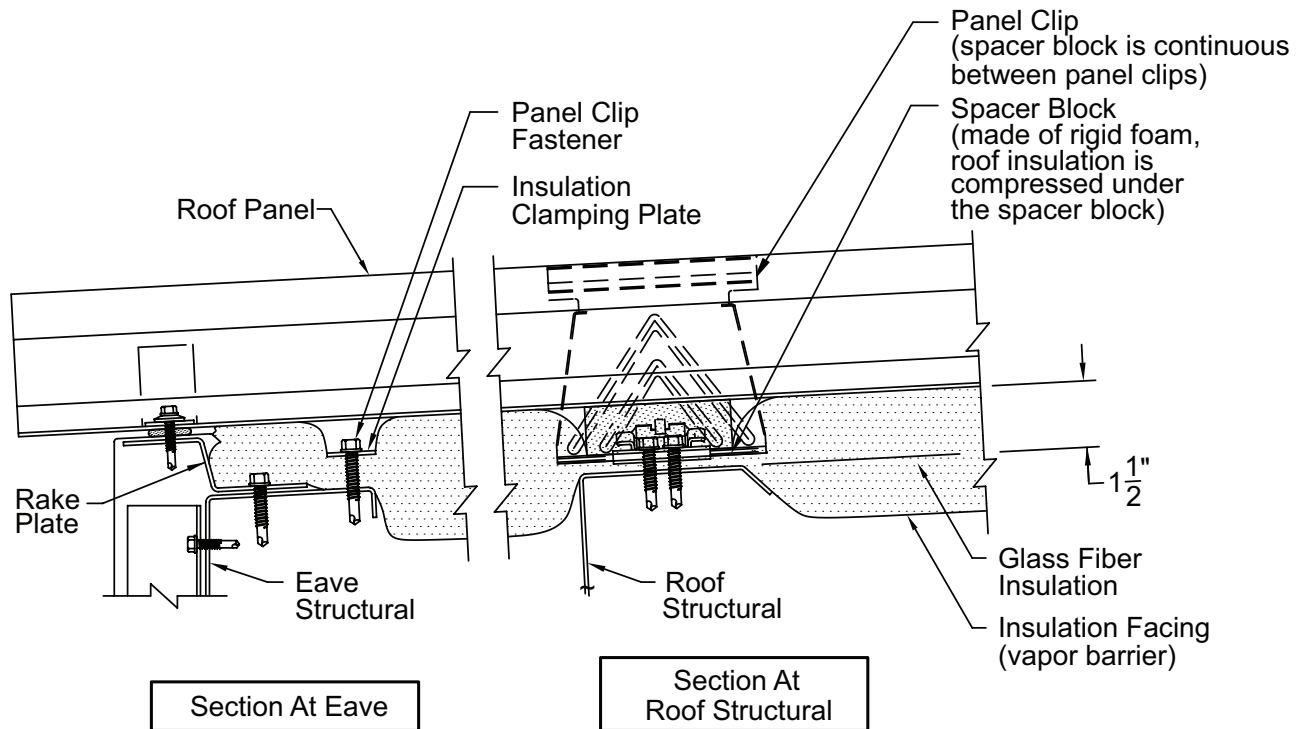

Insulation Note
 $1\frac{1}{2}$ " Standoff Is Recommended For Up To 4" Thick Insulation.
 $1\frac{1}{2}$ " Standoff Is Recommended For 4" To 6" Thick Insulation.

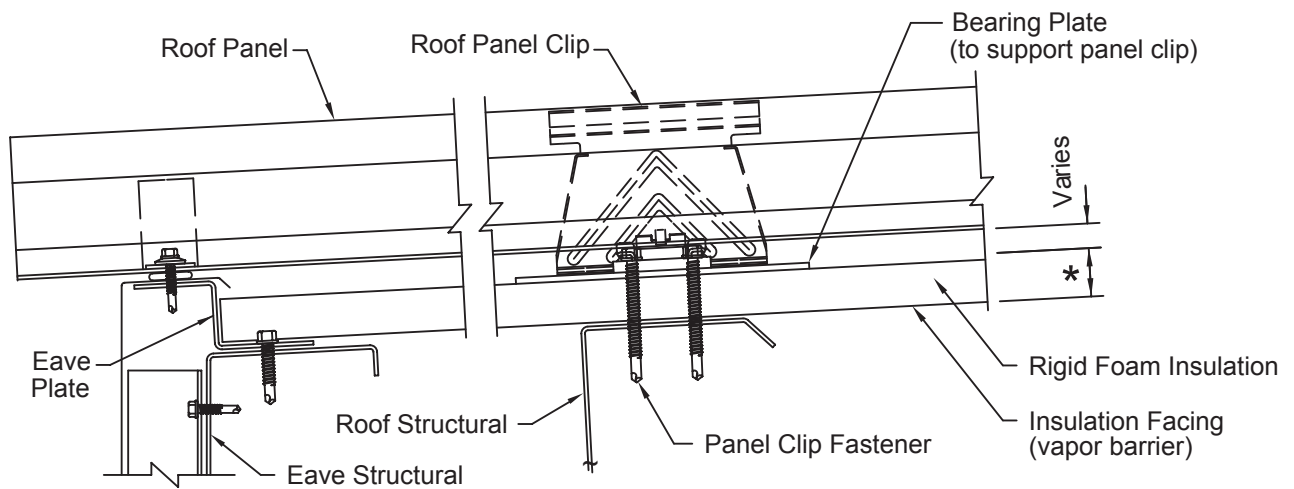

Section At Eave

Section At
Roof Structural

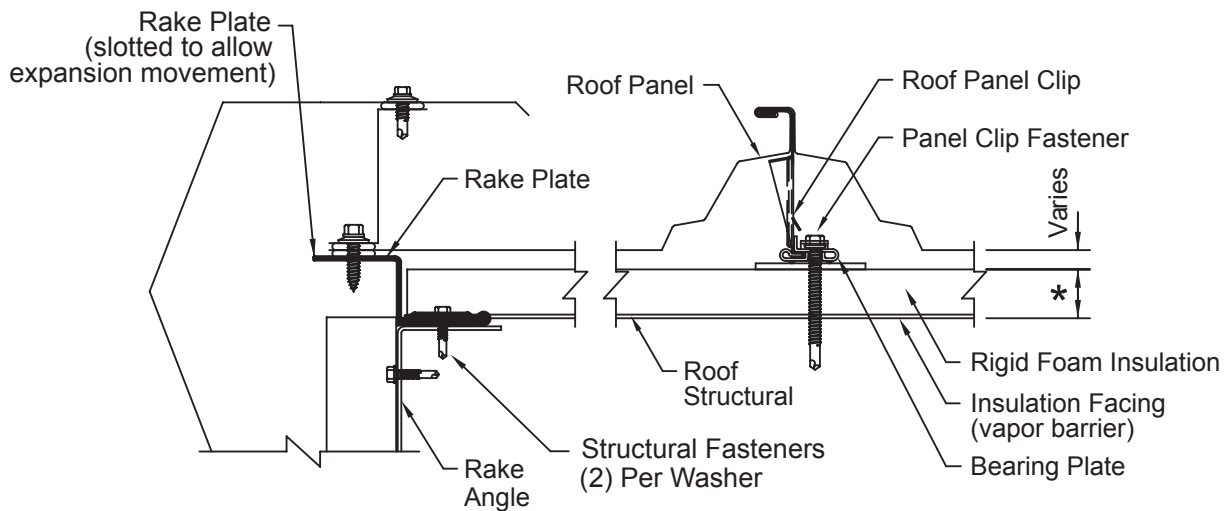

Section At Rake

* Notes

Rigid Foam Insulation Thickness = 1" to 4"
Rigid Insulation Over 3" Will Require Custom Eave And Rake Plates